



Drybase

liquid applied DPM

Protects against damp, vapour and gases. Can be applied by brush, roller or spray.



Drybase liquid applied DPM is a liquid polymer based barrier coating that can be used to resist the penetration of gases, vapours, water and other liquids.

The recipe is based on a blend of polymers which provide integrity, elasticity and toughness to the formed film. Drybase is applied in two coats by brush, roller or airless spray. One 5 litre tub will cover up to 4.5m², depending upon the substrate surface texture.

Benefits

- Single pack system
- Waterbased and solvent-free
- Quick drying
- Good bond to many substrates
- Low vapour permeability
- Damp proof barrier
- Gas barrier

Applications

- Gas barrier for carbon dioxide, methane and radon
- Damp proof barrier
- Primer before replastering to stop salt attack
- Flood resilience and mitigation
- Timber applications – sunken posts, beams set into a wall, isolation of timber elements to protect against rot etc
- Wet rooms
- Bunds
- Reglet joint

Protects against damp, vapour and gases

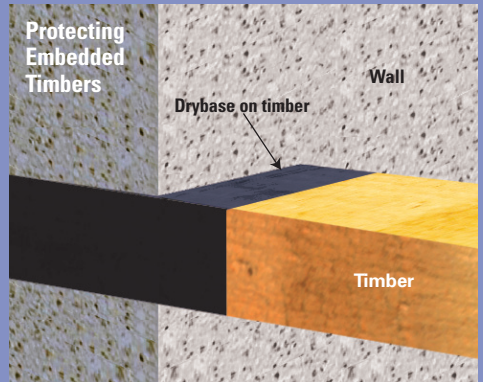
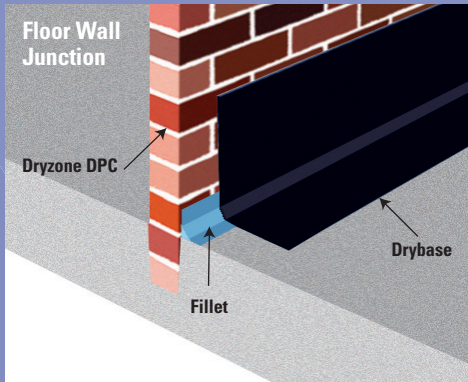

Water (liquid)

Resistant to the passage of water (positive pressure)

Drybase film supported on a porous tile prevented water penetration at 0.2 N/mm² pressure during the 24 hour test period. This is equivalent to a 20-metre head of water (2 bar)

Water (vapour)

Resistant to the passage of water vapour

The water vapour permeability is <4g/m²/24 hours at 25°C/75%RH as measured following BS 3177

Methane

Resistant to methane

Measured independently to have a methane permeability of 79 mL/m²/day which indicates that the membrane is 10 times more resistant than the same thickness of low-density polyethylene

Salt barrier

Resists salt migration

Resistant to the wet transmission of nitrate, chloride and sulphate salts. The salt and moisture test carried out by the University of Portsmouth found that under accelerated test conditions, the moisture content of the gypsum plaster surface was reduced from 37% to 7% by using Drybase in combination with Hardwall plaster

Radon

Provides a barrier to the penetration of radon gas

A 2 mm thick coating was passed as "Radon-Tight" when tested according to the University of Saarland

Applied by brush, roller or spray

Drybase

liquid applied DPM

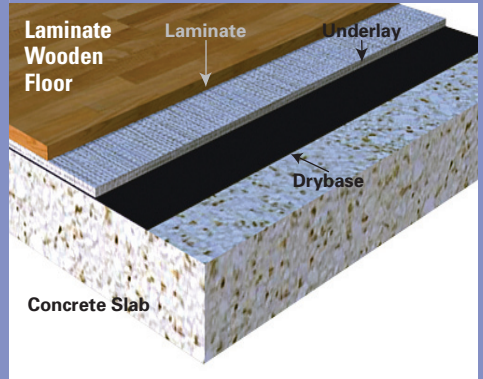
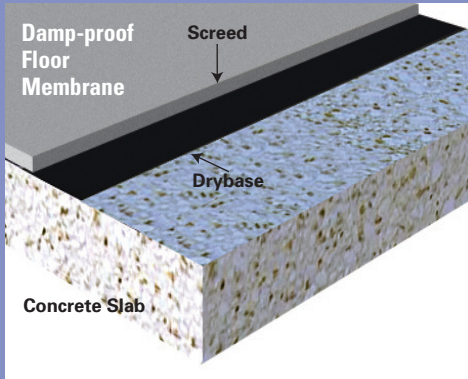

Adhesive Properties

Good adhesion has been measured to the following substrates with the accompanying pull-off forces recorded. The results are for a dry film thickness of 0.6 mm achieved by two layers of Drybase.

Concrete	Pull-off force 1.3 - 2.1 N/mm ² . Pull-off force after 3 month soak in water 1.0 N/mm ²
Brick (Fletton)	2.5 N/mm ²
Lightweight Blocks	0.5 N/mm ² with failure of the block
Plaster Wall	> 1.0 N/mm ²
Timber (softwood)	> 1.0 N/mm ²

Mechanical Properties of Cured Film

Tensile strength	4 N/mm ²
Elongation at break	350 %

Barrier Properties

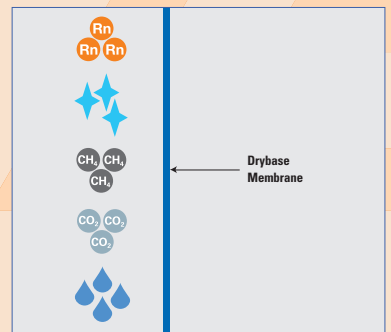

Key

- Rn Radon gas
- ★ Salt crystals
- CH₄ Methane
- CO₂ Carbon dioxide
- 💧 Water

Low odour and solvent-free

Drybase

liquid applied DPM



- **Liquid polymer barrier***
- **Resists penetration of gases, vapours, water and other liquids**
- **Provides integrity, elasticity and toughness**
- **Can be used under laminate flooring, tiles, plaster, screed and timber**

* Not intended as a decorative finish



**Targeted treatment for
Rising Damp**



**Masonry
Protection Cream**



**Concrete protection
and waterproofing**



OLDROYD®

**The ultimate waterproofing
membrane system**

Safeguard have been suppliers of specialist damp-proofing and waterproofing products for over 25 years.

Our focus is on providing high-quality, reliable products to specialist contractors in the construction industry.

Technical Support

At Safeguard we realise the importance of providing first-rate technical support for our product range. Our technical team can be contacted during office hours on 01403 210204 and are happy to discuss projects of any size.

Over 200 technical documents can be viewed or downloaded from our website, **www.safeguardeurope.com** including:

- CAD details
- NBS clauses
- Product datasheets
- Application guidelines
- Product videos
- Case studies

On request we are happy to provide this information in paper copy or DVD format.



Safeguard Europe Ltd.

Redkiln Close, Horsham, West Sussex, United Kingdom. RH13 5QL

Telephone: 01403 210204 Fax: 01403 217529

Email: info@safeguardeurope.com

www.safeguardeurope.com